

see 7/12

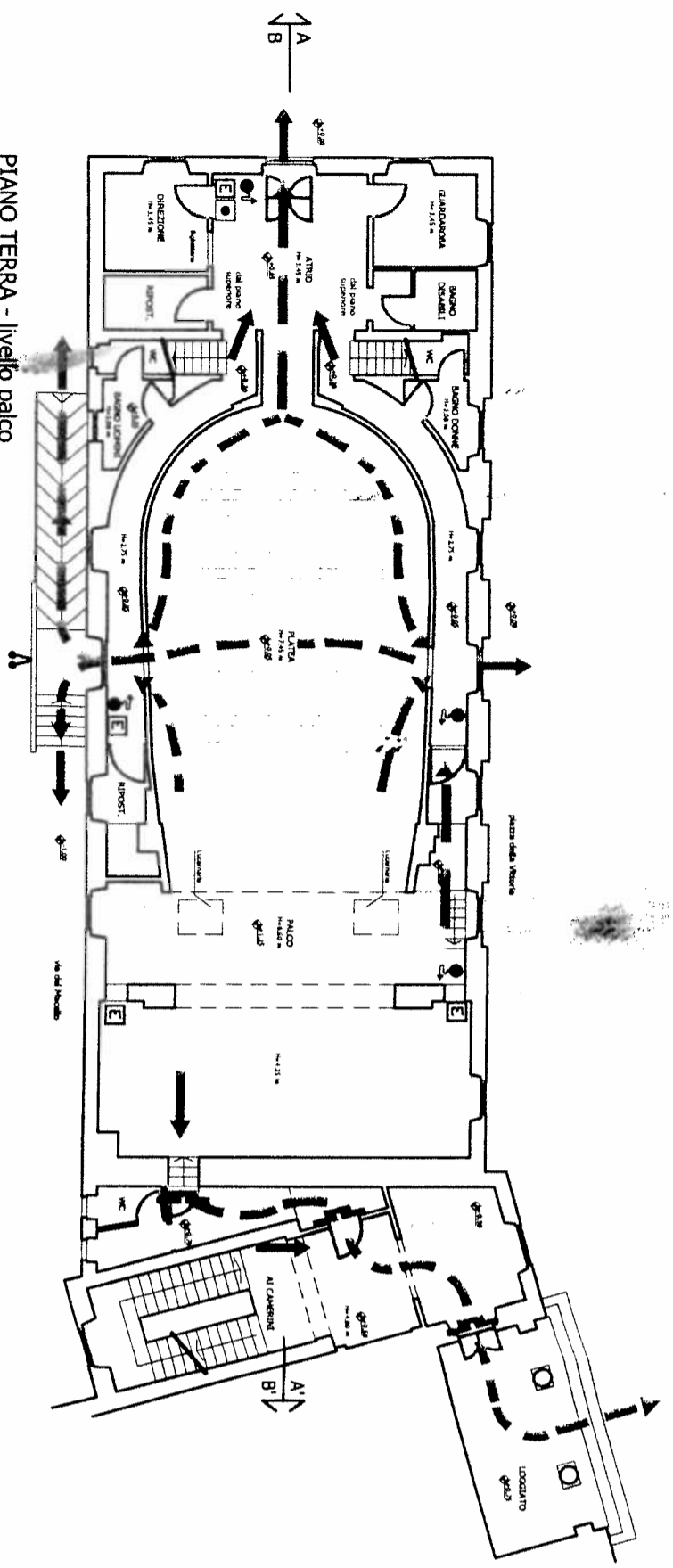

PIANO TERRA - livello palco
quota +1.25 m

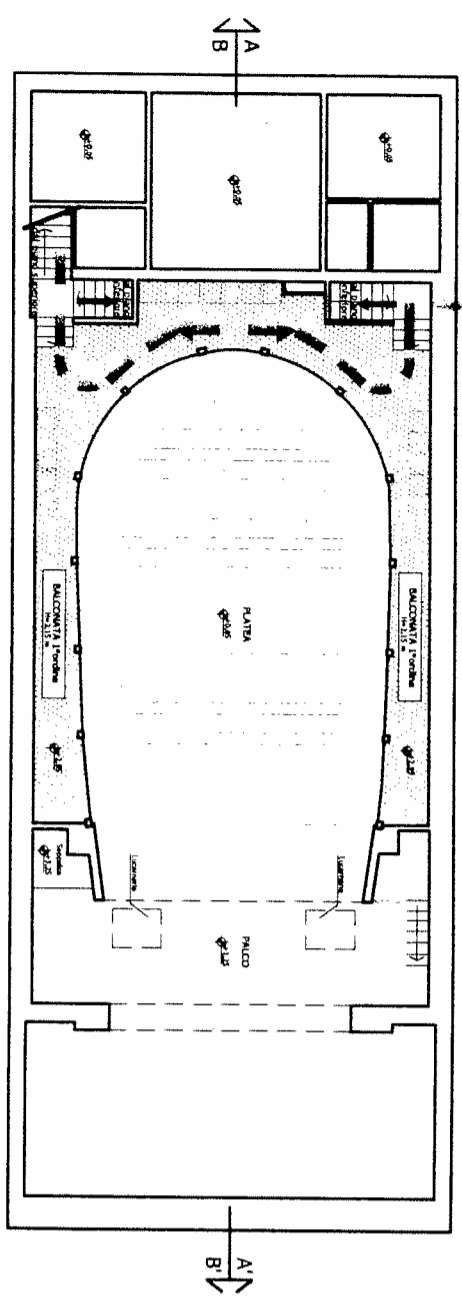



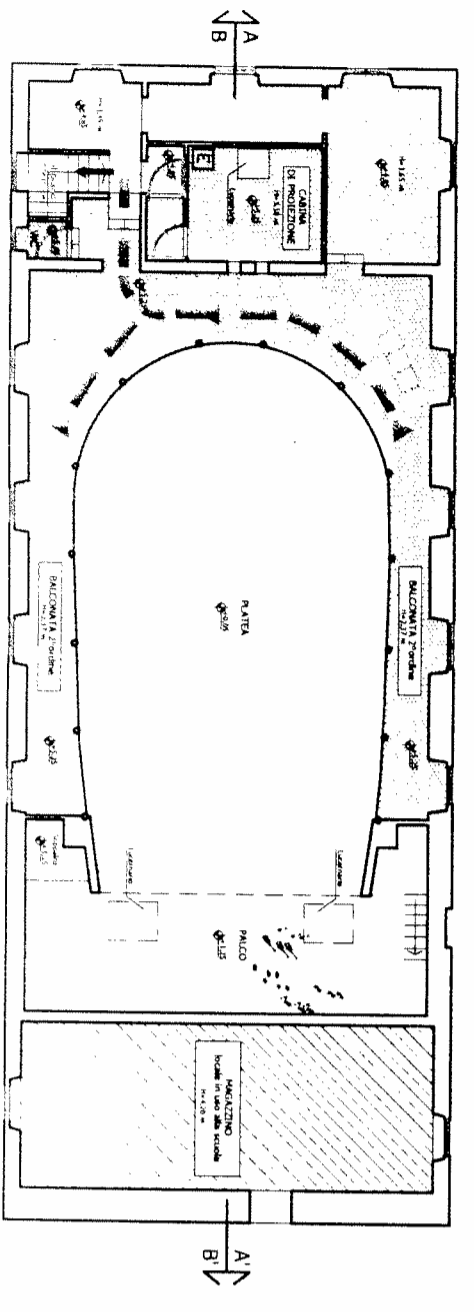









PIANO PRIMO - balconata 1° ordine
quota +3.25 m

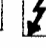

PIANO SECONDO - balconata 2° ordine
quota +4.85 m e +5.25 m

| | | | |
|---|---|---------------|---------------------|
| Cliente: | CINEMA-TEATRO GIOTTO piazza della vittoria 2 - Vicchio di Mugello (FI) | | Aggiornamento: |
| Oggetto: | RICHIESTA DI SOPRALUOGO PER RILASCIO CPI | | Aggiornamento: |
| Contenuto: | PIANI TERRA-PRIMO -SECONDO-SEMINT. | | Data: |
| Disegnato da: | arch. Silvia Recami | Approvato da: | Ing. Alberto Recami |
|  | Via Pagnini 19 - 50134 Firenze tel 055-456894 fax 1782279303 email areco@bsccall.it | | Scale: |
| | | | 1:200 |
| | | | Tavola: |
| | | | CPI 1/2 |

LEGENDA SIMBOLI ANTINCENDIO

-  ESTINTORE PORTATILE
-  ESTINTORE CARRELLATO
-  IDRANTE
-  ATTACCO WF
-  QUADRO ELETTRICO
-  PULSANTE DI ALLARME ANTINCENDIO
-  PORTA REI
-  PARETE REI
-  VALVOLA INTERCETTAZIONE GAS
-  IMPIANTO GAS
-  IMPIANTO IDRICO ANTINCENDIO
-  USCITA IN PIANO
-  USCITA VERSO IL BASSO

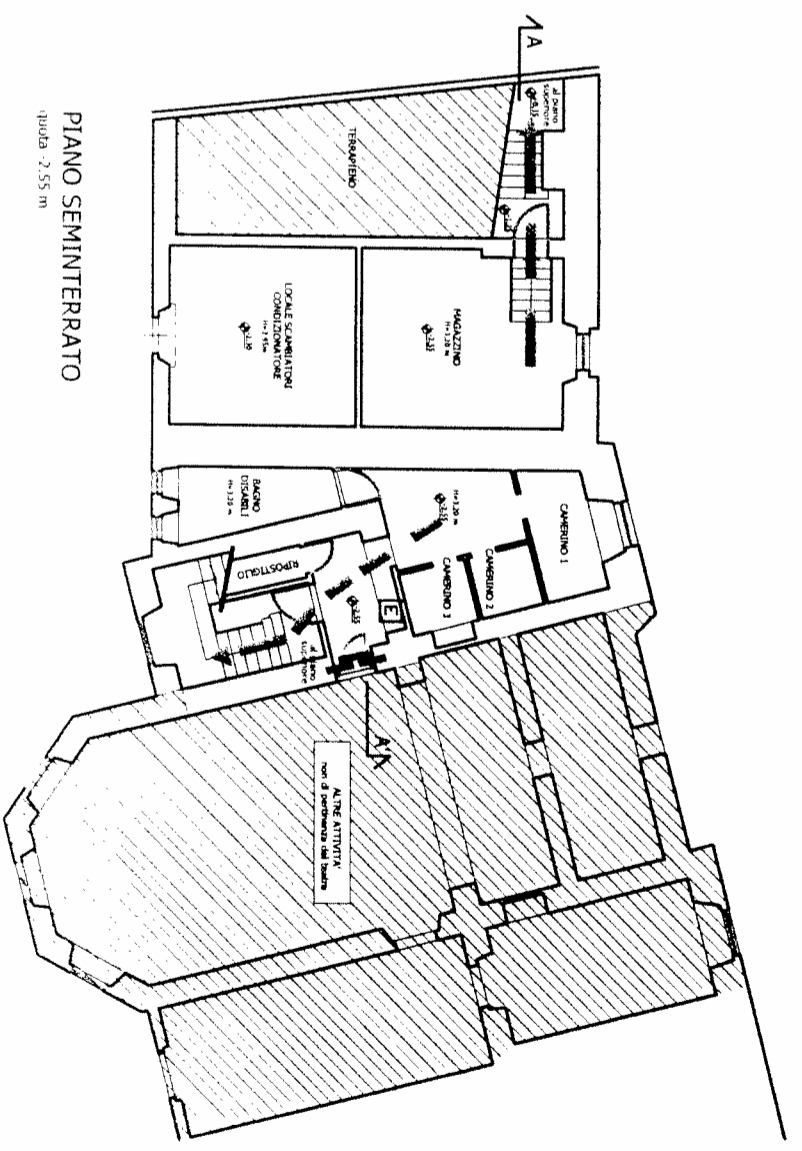

PIANO SEMINTERATO
quota -2.55 m